

Công ty CP Đầu tư và Thương mại Tân Kỳ Nguyên - www.tankynguyen.com.vn - Hanoi: 01275 8888 99 - HCM: 0906 778 338

TO OBTAIN A SAFE AND RELIABLE PERFORMANCE

Make sure that:

- > Side panels bears on the floor at the same level. A carpet can be placed beneath both said adjacent bearing sides, but do not place carpet or any shim beneath on side desk or body side alone.
- > Stand at the middle of the furniture to make the transformation.
- > Avoid excessive or too asymmetric loads on desks.
- > While lowering, please verify that bed bottom does not touch things left on the desk. Things left on the desk cannot exceed 18 inches height. Next to the rear of the desk there is less height available.
- > As with a door or a rocking chair, take good care not to trap fingers between closing parts.
- > If power or signal cables are to be installed, consult a qualified person.
- > Ask your supplier for more details

WEIGHT LOAD SPECIFICATION

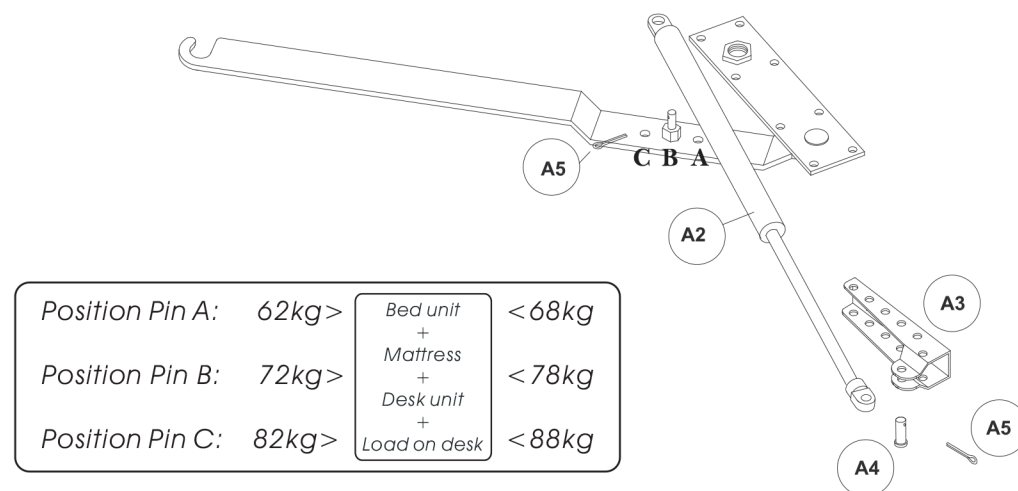

! RIGHT SIDE SHOWN
Do the same with left side symmetrically

FURNITURE PARTS LIST

BODY PARTS

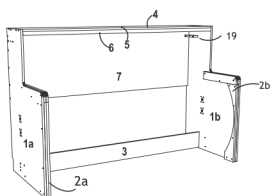

COMPONENTS		
Part N°	Name	Qty.
1a+1b	Body Side L/R	1+1
2a+2b	Body Side Concealer L/R	1+1
3	Bottom Stretcher	1
4	Body Top	1
5	Top Stretcher	1
6	Shelf Stiffener	1
7	Body Back	1
19	Bed Stop	2

BED PARTS

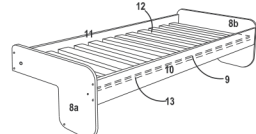

COMPONENTS		
Part N°	Name	Qty.
8a+8b	Bed Head L/R	1+1
9	Slat Cover	1
10	Front Bed Rail	1
11	Rear Bed Rail	1
12	Bed Slats	12
13	Slat Cleats	2

DESK PARTS

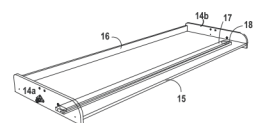

COMPONENTS		
Part N°	Name	Qty.
14a+14b	Desk Side L/R	1+1
15	Desk Top	1
16	Desk Back	1
17	Desk Stiffener	1
18	Tube Cover	1
	Wood Plug	2

MECHANISM LIST

A1 Mech-Arm Plate 2 pcs	A2 Gas Spring 2 pcs	A3 Lower Support 2 pcs	A4 Lower Support Pin 2 pcs	A5 Cotter Pin 2 pcs	A6 BEARER 2 pcs	A7 LINK/PIVOT 2 sets
A8 Turnion Bushing & Screw 2 sets	A9 Lock 2 pcs	A10 Lock Bushing 4 pcs	T1 Antiwear Lubricant M4 L-KEY 1 pcs			

HARDWARE LIST

			Qty.
	Confirmat	H2, 7 x 70	34
	Screw, Ph head	H10, 4,5 x 45	42
	Screw, Ph head	H20, 4,5 x 30	28
	Screw, Ph head	H9, 4,5 x 20	5
	Screw, Ph head	H13, 3,5 x 40	9
	Screw, Ph head	H4, 3,5 x 16	4
	Dowell	8 x 16	28
	Bolt & nut	H3, 1/4 x 1 1/4	12

Total: 162 pcs

BODY ASSEMBLY

- 1** Attach plate (A1) to body side (1). Make sure the hook on the arms is facing upwards.

- 2** Attach lower support (A3) to body (1) but do not over tighten.

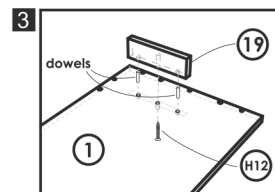
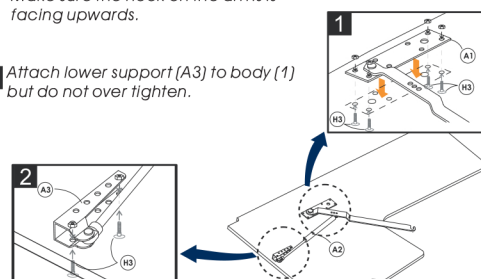

Attach bed stop (19) to body side (1) using dowels and screw H2

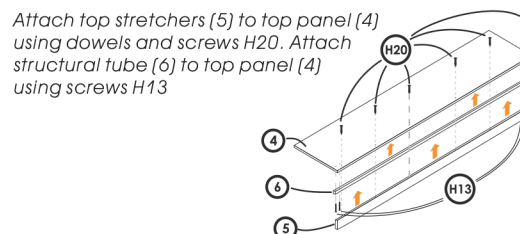

Attach body sides (1) to bottom stretcher (2) and top stretchers (3) fixed using dowels and screws H2

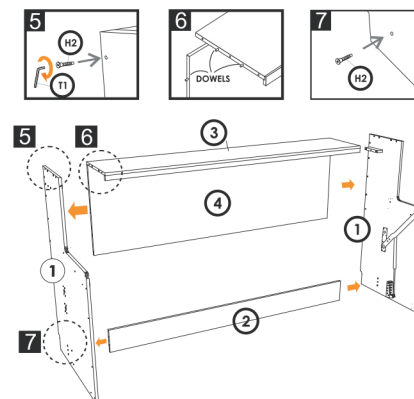

DESK ASSEMBLY

- 8** Attach desk back (9) to desk top (7) with screws H2

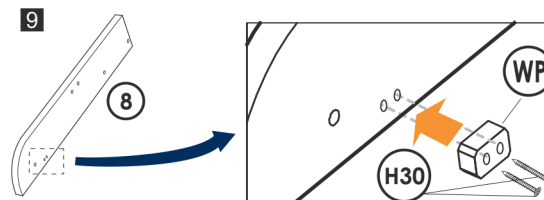
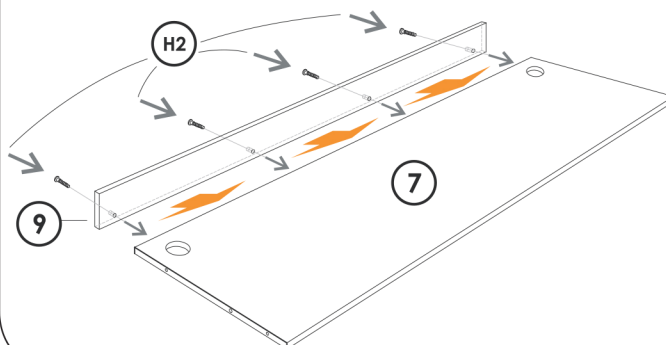

Screw wood plugs (WP) to inner side of desk sides (8)

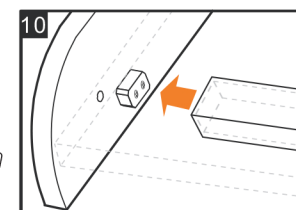
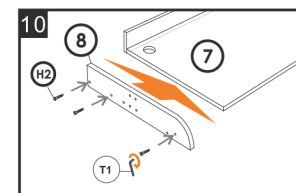

Attach one of the desk sides (8) to the desk top (7) using dowels and screws H2. Then insert wood plug (WP) into the desk stiffener.

DESK ASSEMBLY

- 11** Attach the other desk side to the desk top using dowels and screws H2 and inserting the wood plug into the desk stiffener

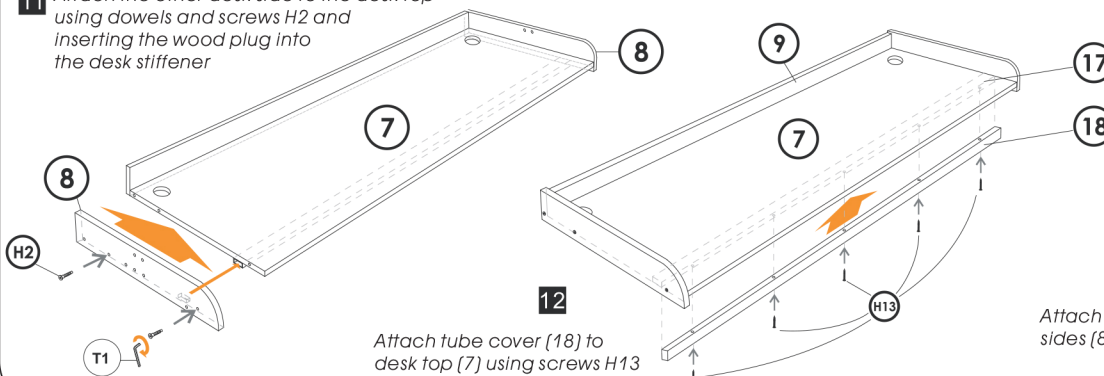

Attach tube cover (18) to desk top (7) using screws H13

Attach the bearer (A6) to the desk sides (8) using screw H6

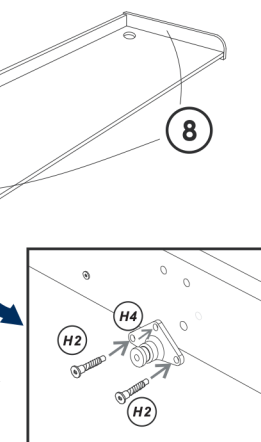

BODY ASSEMBLY

- 14** Attach front rail (10) and rear rail (11) to bed heads (8) with dowels and screws (H2).
Be careful, put cleats inside. Perforations for slats should be pointing bed up (Down in sketch position)!!

Slats and slats cover must be attached to the bed after the bed was attached to the body side.

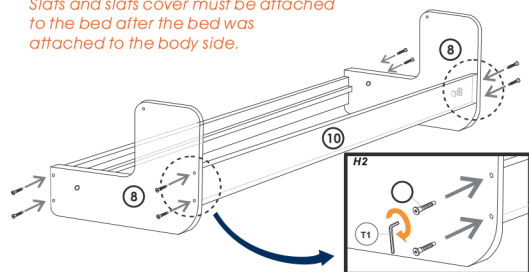

- 17** Fix the remaining triangle plates (A7) with link screws to link pivot. Tighten screws, re-check tightening all screws. Slide body carefully in order to align plates with bed head holes. Then standing at rear side of body, introduce trunnion bushing (8) with screws. Screw in a few turns, and let loose. Repeat at the other side. Tighten screws (A8) strongly.

! Avoid scratching bed head (11) and desk side (8) with mech arm (A1)

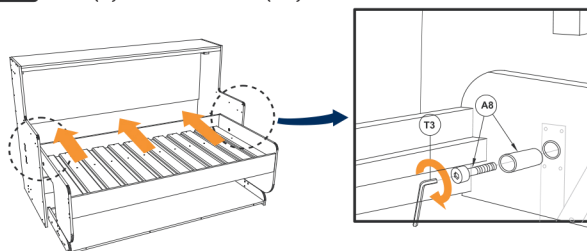

FINAL ASSEMBLY

! All the rotating metal parts (pin arm, support pin, triangle link rollers, trunnion) must be greased.

- 15** Assemble two links pivot sets attaching three link bushings to one triangle plate (outer cones to bushing) using link screws.

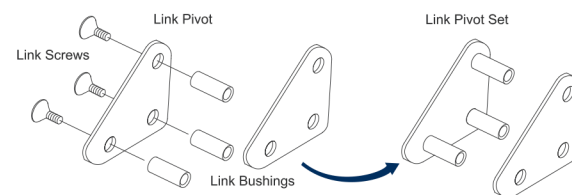

- 16** Put bed heads bearing on desk sides carefully, aligning holes (see detail in step 2) provided for link bushings. In both sides in turn, place from outside the link pivot set into link holes as shown. Slightly displacing or rising the bed as required to push the link in place.

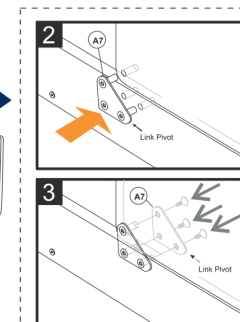
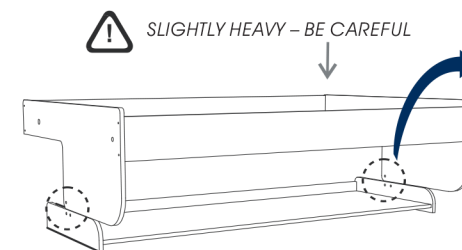

- 19** Attach the concealers to the body side. The bottom part should be attached after the mechanism arm is placed in the tribearer to ease the positioning of the arm. Place the plastic bushing (A10) in the concealer perforations for the locks.

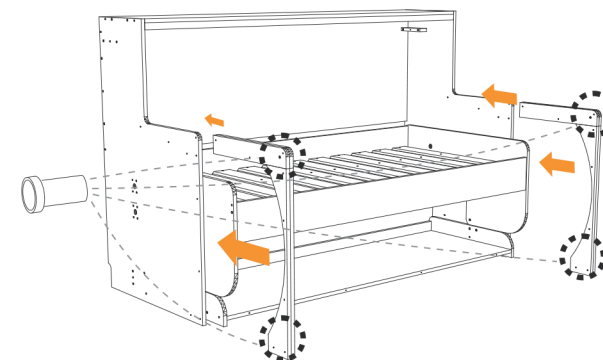

- 18** Place the bed cover over the slat cleat. Pull all screws (10) through the bed slats (12) and through bed cover (9) to screw in slat cleat.

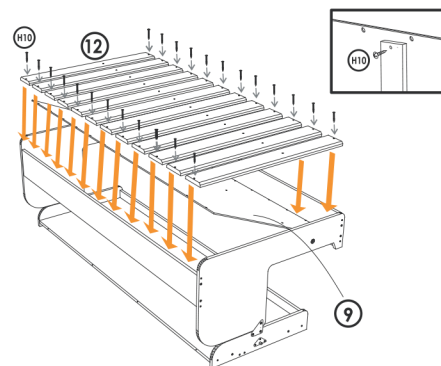

- 19** Lift the bed slowly, taking care of keeping the desk in horizontal position. Once in upper position, lock the desk by pushing in the lock at both sides.
- !** CAUTION!!
1-EXTRA STRENGTH REQUIRED
We recommend to sit on the floor and pull strongly
2-TAKE CARE OF YOUR FINGERS
Do not put fingers in the hook. Hold the arm as shown

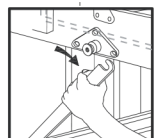

Slowly pull mech arm downwards

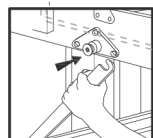

Gently push mech arm to the inner side of bearer

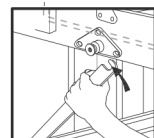

Slowly release mech arm upwards to engage the bearer slotting.

SAFETY PRECAUTIONS

- 20** Use the brackets to fix the body top to the wall. The wall endurance should be checked also the proper anchor and screw length. First attach the bracket to the body top using the proper screw then attach the bracket to wall using screws and plastic anchors.

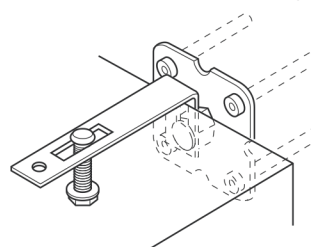

Brackets not supplied

Use the lock placed at the desk side to safe use in bed and desk position.

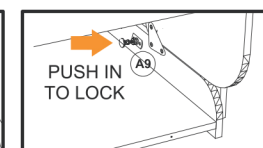
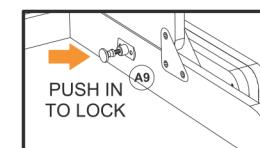

ASSEMBLY HAS FINISHED

For proper use:

- > Check that the floor is clear to lower the bed.
- > Unlock to change from desk to bed position and lock again.
- > Stand at the middle of the furniture to pull from bed beam and push down the desk to make the transformation.
- > The mechanism is already calibrated to work with the mattress on and a weight similar to 25kg on the desk.
- > Do not forget to place mattress for adequate functioning.

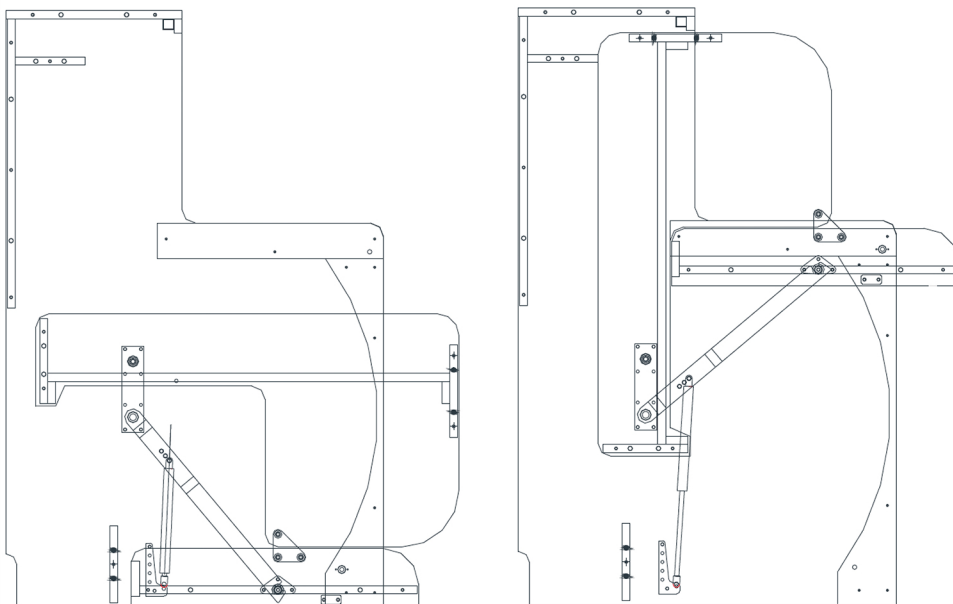

*More desk bed model
Please Contact us*

To open the bed and move the desk down, first unlock the desk then grab the front bed rail with a hand and push down the desk with the other.

To close the , unlock the locking device and pull up the front bed rail. Always stand at the middle of the furniture to make the transformation and grab the parts from its center.

It is important to lock the locking device after the transformation and before the use of the desk or the bed.

The system is based on a desk/bed balance. Unbalanced system may result on having to apply extra force when transforming from bed to desk and vice versa. Pin Arm position on arm (A,B,C) helps to balance unbalanced system (less than 20kg and more than 20kg on desk, less than 10kg and more than 20 kg on bed).

Side panels bears on the floor at the same level. A carpet can be placed beneath both said adjacent bearing sides, but do not place carpet or any shim beneath on side desk or body side alone. Avoid excessive or too asymmetric loads on desk.

While lowering, please verify that bed bottom does not touch things left on the desk. Things left on the desk cannot exceed 18 inches height. Next to the rear of the desk there is less height available.

As with a door or a rocking chair, take good care not to trap fingers between closing parts.

If power or signal cables are to be installed, consult a qualified person.

If the bed does not stay down by itself, lock the locking device.

Ask your supplier for more details.